

REELPOWER

INDUSTRIAL

PRECISION WINDING EXPERTS

QUICK START GUIDE

WHEEL GUARD ASSEMBLY

FOR THE 1700, 1700SP & 1700SL

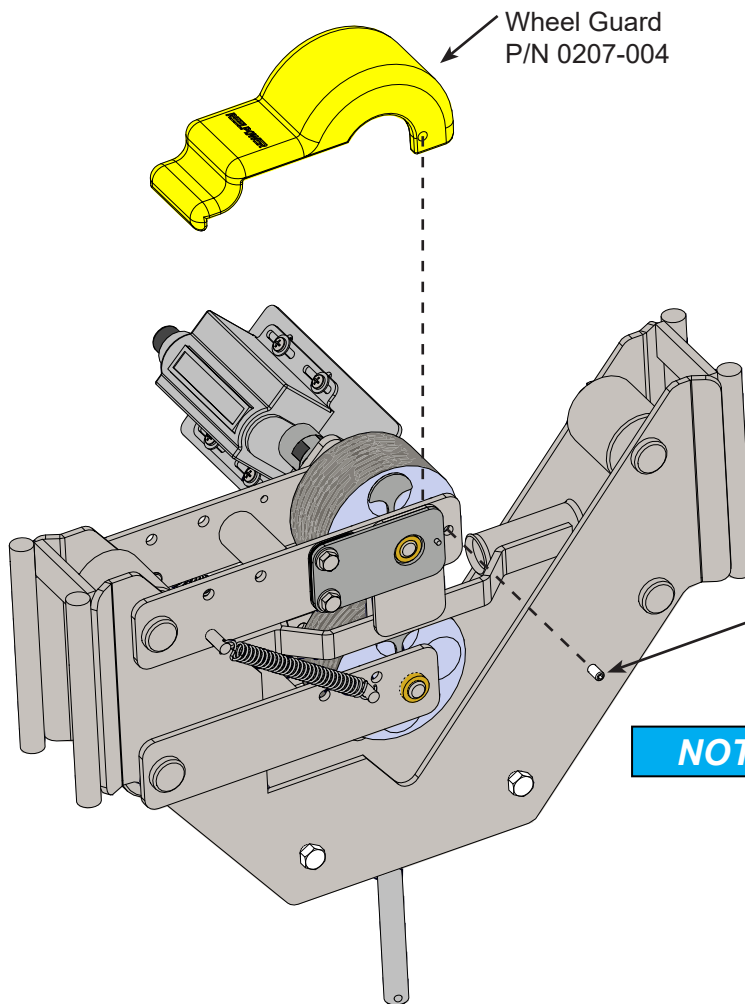
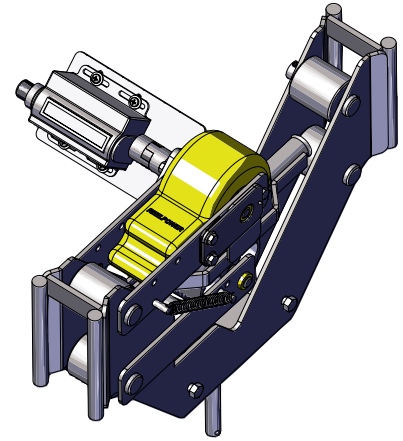

NOTICE

Be sure the set screw is installed flush with plate so that the fairlead tube arm can still rotate.

- 1.) Position guard over wheel.
- 2.) Align guard with hole in bracket.
- 3.) Use hex screw to tighten guard to bracket.
- 4.) Hex screw installed opposite side of counter.



SG-0001-A-1023

5101 S. Council Road, Suite 100 • Oklahoma City, Oklahoma 73179
Toll Free: 888-873-4000 • Telephone: 405-672-0000 • Fax: 405-672-7200
Email: sales@reelpower.com • Website: www.reelpowerind.com